

**DEPARTMENT OF  
CITY PLANNING**

COMMISSION OFFICE  
(213) 978-1300

CITY PLANNING COMMISSION

SAMANTHA MILLMAN  
PRESIDENT

VAHID KHORSAND  
VICE-PRESIDENT

DAVID H. J. AMBROZ  
CAROLINE CHOE

KAREN MACK

MARC MITCHELL

VERONICA PADILLA-CAMPOS

DANA M. PERLMAN  
VACANT

**CITY OF LOS ANGELES  
CALIFORNIA**



ERIC GARCETTI  
MAYOR

**EXECUTIVE OFFICES**

200 N. SPRING STREET, ROOM 525  
LOS ANGELES, CA 90012-4801  
(213) 978-1271

VINCENT P. BERTONI, AICP  
DIRECTOR

KEVIN J. KELLER, AICP  
EXECUTIVE OFFICER

SHANA M.M. BONSTIN  
DEPUTY DIRECTOR

TRICIA KEANE  
DEPUTY DIRECTOR

ARTHI L. VARMA, AICP  
DEPUTY DIRECTOR

LISA M. WEBBER, AICP  
DEPUTY DIRECTOR

Decision Date: March 26, 2019

**Applicant/Owner**

Focus Line, LLC  
Fred Larian  
160 Delfern Drive  
Los Angeles, CA 90077

**Case No.** AA-2017-5222-PMLA  
**CEQA:** ENV-2017-5223-CE  
**Location:** 11512-11516 West Mississippi Avenue

**Representative**

Tala Associates  
Kamran Kazemi  
1916 Colby Avenue  
Los Angeles, CA 90025

**Council District:** 11 – Bonin  
**Neighborhood Council:** West Los Angeles Sawtelle  
**Community Plan Area:** West Los Angeles  
**Land Use Designation:** Low Medium I Residential  
**Zone:** R2-1  
**Legal Description:** Lots: 2-3 ; Block None; Tract: TR 8725

**Last Day to File an Appeal:** April 10, 2019

In accordance with provisions of Section 17.51 and 17.53 of the Los Angeles Municipal Code (LAMC), the Advisory Agency determined, based on the whole administrative record, that the project is exempt from CEQA pursuant to State CEQA Guidelines Article 19, Sections 15315 (Class 15) and 15332 (Class 32), and there is no substantial evidence demonstrating that an exception to a categorical exemption, pursuant to Section 15300.2, applies. The Advisory Agency also approves Parcel Map No. AA-2017-5222-PMLA composed of two (2) lots, located at 11512-11516 West Mississippi Avenue for a maximum of **four (4) residential condominium units**, as shown on map stamp-dated November 19, 2018. This unit density is based on the R2-1 Zone. (The subdivider is hereby advised that the LAMC may not permit this maximum approved density. Therefore, verification should be obtained from the Department of Building and Safety which will legally interpret the Zoning Code as it applies to this particular property.) The Advisory Agency's approval is subject to the following conditions:

**NOTE** on clearing conditions: When two or more **agencies** must clear a condition, subdivider should follow the sequence indicated in the condition. For the benefit of the applicant, subdivider shall maintain record of all conditions cleared, including all material supporting clearances and be prepared to present copies of the clearances to each reviewing agency as may be required by its staff at the time of its review.

**DEPARTMENT OF BUILDING AND SAFETY, GRADING DIVISION**

*Grading Division approvals are conducted at 221 North Figueroa Street, 12<sup>th</sup> Floor suite 1200. The approval of this Tract Map shall not be construed as having been based upon a geological investigation such as will authorize the issuance of the building permit of the subject property. Such permits will be issued only at such time as the Department of Building and Safety has received such topographic maps and geological reports as it deems necessary to justify the issuance of such building permits.*

1. Comply with any requirements with the Department of Building and Safety, Grading Division for recordation of the final map and issuance of any permit.

**DEPARTMENT OF BUILDING AND SAFETY, ZONING DIVISION**

*An appointment is required for the issuance of a clearance letter from the Department of Building and Safety. The applicant is asked to contact Laura Duong at (213) 482-0434 to schedule an appointment.*

2. That prior to recordation of the final map, the Department of Building and Safety, Zoning Division shall certify that no Building or Zoning Code violations exist on the subject site. In addition, the following items shall be satisfied:
  - a. Show all street dedication as required by Bureau of Engineering and provide net lot area after all dedication. "Area" requirements shall be re-checked as per net lot area after street dedication. Front yard requirements shall be required to comply with current code as measured from new property lines after dedication.

**Notes:**

The submitted Map may not comply with the number of guest parking spaces required by the Advisory Agency.

Any proposed structures or uses on the site have not been checked for and shall comply with Building and Zoning Code requirements. Plan check will be required before any construction, occupancy or change of use.

**DEPARTMENT OF TRANSPORTATION**

*Please contact this section at (213) 482-7024 for any questions regarding the below.*

3. That prior to recordation of the final map, satisfactory arrangements shall be made with the Department of Transportation to assure:
  - a. A minimum of 20-foot reservoir space be provided between any security gate(s) and the property line or to the satisfaction of the Department of Transportation or to the satisfaction of Los Angeles Department of Transportation (LADOT).
  - b. Parking stalls shall be designed so that a vehicle is not required to back into or out of any public street or sidewalk.
  - c. A parking area and driveway plan be submitted to the Citywide Planning Coordination Section of the Department of Transportation for approval prior to submittal of building permit plans for plan check by the Department of Building and Safety. Transportation approvals are conducted at 201 N. Figueroa Street Suite 550, Station 3.
  - d. That a fee in the amount of \$205 be paid for the Department of Transportation as required per Ordinance No. 180542 and LAMC Section 19.15 prior to recordation of the final map. Note: the applicant may be required to comply with any other applicable fees per this new ordinance.

**FIRE DEPARTMENT**

*The applicant is further advised that all subsequent contact regarding these conditions must be with the Hydrant and Access Unit. This would include clarification, verification of condition compliance and plans or building permit applications, etc., and shall be accomplished BY APPOINTMENT ONLY, in order to assure that you receive service with a minimum amount of waiting please call (213) 482-6509. You should advise any consultant representing you of this requirement as well.*

4. That prior to the recordation of the final map, a suitable arrangement shall be made satisfactory to the Fire Department, binding the subdivider and all successors to the following:
  - a. Submittal of plot plans for Fire Department review and approval prior to recordation of Tract Map Action.
  - b. Access for Fire Department apparatus and personnel to and into all structures shall be required.
  - c. 505.1 Address identification. New and existing buildings shall have approved building identification placed in a position that is plainly legible and visible from the street or road fronting the property.
  - d. The entrance or exit of all ground dwelling units shall not be more than 150 feet from the edge of a roadway of an improved street, access road, or designated fire lane.
  - e. No building or portion of a building shall be constructed more than 150 feet from the edge of a roadway of an improved street, access road, or designated fire lane.
  - f. Where rescue window access is required, provide conditions and improvements necessary to meet accessibility standards as determined by the Los Angeles Fire Department.
  - g. Site plans shall include all overhead utility lines adjacent to the site.
  - h. Any roof elevation changes in excess of 3 feet may require the installation of ships ladders.
  - i. The Fire Department may require additional roof access via parapet access roof ladders where buildings exceed 28 feet in height, and when overhead wires or other obstructions block aerial ladder access.
  - j. Adequate off-site public and on-site private fire hydrants may be required. Their number and location to be determined after the Fire Department's review of the plot plan.

**BUREAU OF STREET LIGHTING – SPECIFIC CONDITIONS**

*Street Lighting clearance for this Street Light Maintenance Assessment District condition is conducted at 1149 S. Broadway Suite 200. Street Lighting improvement condition clearance will be conducted at the Bureau of Engineering District office, see condition S-3. (c).*

5. Prior to the recordation of the final map or issuance of the Certificate of Occupancy (C of O), street lighting improvement plans shall be submitted for review and the owner shall provide a good faith effort via a ballot process for the formation or annexation of the property within the boundary of the development into a Street Lighting Maintenance Assessment District.

**BUREAU OF SANITATION**

6. Wastewater Collection Systems Division of the Bureau of Sanitation has inspected the sewer/storm drain lines serving the subject tract and found no potential problems to their structure or potential maintenance problem, as stated in the memo dated December 31, 2018. Upon compliance with its conditions and requirements, the Bureau of Sanitation, Wastewater Collection Systems Division will forward the necessary clearances to the Bureau of Engineering. (This condition shall be deemed cleared at the time the City Engineer clears Condition No. S-1. (d).)

**INFORMATION TECHNOLOGY AGENCY**

7. To assure that cable television facilities will be installed in the same manner as other required improvements, please email [cabletv.ita@lacity.org](mailto:cabletv.ita@lacity.org) that provides an automated response with the instructions on how to obtain the Cable TV clearance. The automated response also provides the email address of three people in case the applicant/owner has any additional questions.

**DEPARTMENT OF RECREATION AND PARKS**

8. That the Park Fee paid to the Department of Recreation and Parks be calculated as a Subdivision (Quimby in-lieu) fee.

**URBAN FORESTRY DIVISION AND THE DEPARTMENT OF CITY PLANNING**

9. Plant street trees and remove any existing trees within dedicated streets or proposed dedicated streets as required by the Urban Forestry Division of the Bureau of Street Services. Parkway tree removals shall be replaced at a 2:1 ratio. All street tree plantings shall be brought up to current standards. When the City has previously paid for tree plantings, the subdivider or contractor shall notify the Urban Forestry Division at (213) 847-3077 upon completion of construction to expedite tree planting.

Note: Removal or planting of any tree in the public right-of-way requires approval of the Board of Public Works. Contact Urban Forestry Division at: (213) 847-3077 for permit information.

**DEPARTMENT OF CITY PLANNING - SITE SPECIFIC CONDITIONS**

*Clearances may be conducted at the Figueroa, Valley, or West Los Angeles Development Services Centers. To clear conditions, an appointment is required, which can be requested at [planning.lacity.org](http://planning.lacity.org).*

10. Prior to the recordation of the final map, the subdivider shall prepare and execute a Covenant and Agreement (Planning Department General Form CP-6770) in a manner satisfactory to the Planning Department, binding the subdivider and all successors to the following:
  - a. Limit the proposed development to a maximum of four (4) dwelling units.
  - b. Provide a minimum of 2 covered off-street parking spaces per dwelling unit. Lots with less than 50 feet frontage shall have one guest parking provided on site.

In addition to the above, provide a minimum of ½ guest parking spaces per dwelling. All guest spaces shall be readily accessible, conveniently located, specifically reserved for guest parking, posted and maintained satisfactory to the Department of Building and Safety.

If guest parking spaces are gated, a voice response system shall be installed at the gate. Directions to guest parking spaces shall be clearly posted. Tandem parking spaces shall not be used for guest parking.

In addition, prior to issuance of a building permit, a parking plan showing off-street parking spaces, as required by the Advisory Agency, be submitted for review and approval by the Department of City Planning.

- c. A covenant or reciprocal vehicle and pedestrian access easement between Parcels A and B shall be recorded.
- d. No structure or barrier shall be permitted within the reciprocal vehicle and pedestrian access easement.
- e. That prior to issuance of a certificate of occupancy, a minimum 6-foot-high slumpstone or decorative masonry wall shall be constructed adjacent to neighboring residences, if no such wall already exists, except in required front yard.
- f. That a solar access report shall be submitted to the satisfaction of the Advisory Agency prior to obtaining a grading permit.
- g. That the subdivider consider the use of natural gas and/or solar energy and consult with the Department of Water and Power and Southern California Gas Company regarding feasible energy conservation measures.
- h. INDEMNIFICATION AND REIMBURSEMENT OF LITIGATION COSTS.

Applicant shall do all of the following:

- (i) Defend, indemnify and hold harmless the City from any and all actions against the City relating to or arising out of, in whole or in part, the City's processing and approval of this entitlement, including but not limited to, an action to attack, challenge, set aside, void or otherwise modify or annul the approval of the entitlement, the environmental review of the entitlement, or the approval of subsequent permit decisions, or to claim personal property damage, including from inverse condemnation or any other constitutional claim.
- (ii) Reimburse the City for any and all costs incurred in defense of an action related to or arising out of, in whole or in part, the City's processing and approval of the entitlement, including but not limited to payment of all court costs and attorney's fees, costs of any judgments or awards against the City (including an award of attorney's fees), damages, and/or settlement costs.
- (iii) Submit an initial deposit for the City's litigation costs to the City within 10 days' notice of the City tendering defense to the Applicant and requesting a deposit. The initial deposit shall be in an amount set by the City Attorney's Office, in its sole discretion, based on the nature and scope of action, but in no event shall the initial deposit be less than \$50,000. The City's failure to notice or collect the deposit does not relieve the Applicant from responsibility to reimburse the City pursuant to the requirement in paragraph (ii).
- (iv) Submit supplemental deposits upon notice by the City. Supplemental deposits may be required in an increased amount from the initial deposit if found necessary by the City to protect the City's interests. The City's failure to notice or collect the deposit does not relieve the Applicant from responsibility to reimburse the City pursuant to the requirement in paragraph (ii).

- (v) If the City determines it necessary to protect the City’s interest, execute an indemnity and reimbursement agreement with the City under terms consistent with the requirements of this condition.

The City shall notify the applicant within a reasonable period of time of its receipt of any action and the City shall cooperate in the defense. If the City fails to notify the applicant of any claim, action, or proceeding in a reasonable time, or if the City fails to reasonably cooperate in the defense, the applicant shall not thereafter be responsible to defend, indemnify or hold harmless the City.

The City shall have the sole right to choose its counsel, including the City Attorney’s office or outside counsel. At its sole discretion, the City may participate at its own expense in the defense of any action, but such participation shall not relieve the applicant of any obligation imposed by this condition. In the event the Applicant fails to comply with this condition, in whole or in part, the City may withdraw its defense of the action, void its approval of the entitlement, or take any other action. The City retains the right to make all decisions with respect to its representations in any legal proceeding, including its inherent right to abandon or settle litigation.

For purposes of this condition, the following definitions apply:

“City” shall be defined to include the City, its agents, officers, boards, commissions, committees, employees, and volunteers.

“Action” shall be defined to include suits, proceedings (including those held under alternative dispute resolution procedures), claims, or lawsuits. Action includes actions, as defined herein, alleging failure to comply with any federal, state or local law.

Nothing in the definitions included in this paragraph are intended to limit the rights of the City or the obligations of the Applicant otherwise created by this condition.

- i. A Community Maintenance Agreement shall be prepared, composed of all property owners, to maintain all common areas such as trees, landscaping, trash, parking, community driveway, walkways, monthly service for private fire hydrant (if required), etc. Each owner and future property owners shall automatically become party to the agreement and shall be subject to a proportionate share of the maintenance. The Community Maintenance Agreement shall be recorded as a Covenant and Agreement to run with the land. The subdivider shall submit a copy of this Agreement, once recorded, to the Planning Department for placement in the tract file.

**DEPARTMENT OF CITY PLANNING - STANDARD CONDOMINIUM CONDITIONS**

C-1 That approval of this tract constitutes approval of model home uses, including a sales office and off-street parking. Where the existing zoning is (T) or (Q) for multiple residential use, no construction or use shall be permitted until the final map has recorded or the proper zone has been effectuated. If models are constructed under this tract approval, the following conditions shall apply:

- 1. Prior to recordation of the final map, the subdivider shall submit a plot plan for approval by the Development Services Section of the Department of City Planning showing the location of the model dwellings, sales office and off-street parking. The sales office must be within one of the model buildings.

2. All other conditions applying to Model Dwellings under Section 12.22A, 10 and 11 and Section 17.05 O of the Code shall be fully complied with satisfactory to the Department of Building and Safety.
- C-2 Prior to the recordation of the final map, the subdivider shall pay or guarantee the payment of a park and recreation fee based on the latest fee rate schedule applicable. The amount of said fee to be established by the Advisory Agency in accordance with Section 17.12 of the Los Angeles Municipal Code and to be paid and deposited in the trust accounts of the Park and Recreation Fund.
- C-3 That a landscape plan, prepared by a licensed landscape architect, be submitted to and approved by the Advisory Agency in accordance with CP-6730 prior to obtaining any permit. The landscape plan shall identify tree replacement on a 1:1 basis by a minimum of 24-inch box trees for the unavoidable loss of desirable trees on the site. Failure to comply with this condition as written shall require the filing of a modification to this tract map in order to clear the condition.

In the event the subdivider decides not to request a permit before the recordation of the final map, a covenant and agreement satisfactory to the Advisory Agency guaranteeing the submission of such plan before obtaining any permit shall be recorded.

#### **BUREAU OF ENGINEERING - STANDARD CONDITIONS**

- S-1. (a) That the sewerage facilities charge be deposited prior to recordation of the final map over all of the tract in conformance with Section 64.11.2 of the Los Angeles Municipal Code (LAMC).
- (b) That survey boundary monuments be established in the field in a manner satisfactory to the City Engineer and located within the California Coordinate System prior to recordation of the final map. Any alternative measure approved by the City Engineer would require prior submission of complete field notes in support of the boundary survey.
- (c) That satisfactory arrangements be made with both the Water System and the Power System of the Department of Water and Power with respect to water mains, fire hydrants, service connections and public utility easements.
- (d) That any necessary sewer, street, drainage and street lighting easements be dedicated. In the event it is necessary to obtain off-site easements by separate instruments, records of the Bureau of Right-of-Way and Land shall verify that such easements have been obtained. The above requirements do not apply to easements of off-site sewers to be provided by the City.
- (e) That drainage matters be taken care of satisfactory to the City Engineer.
- (f) That satisfactory street, sewer and drainage plans and profiles as required, together with a lot grading plan of the tract and any necessary topography of adjoining areas be submitted to the City Engineer.
- (g) That any required slope easements be dedicated by the final map.
- (h) That each lot in the tract complies with the width and area requirements of the Zoning Ordinance.

- (i) That 1-foot future streets and/or alleys be shown along the outside of incomplete public dedications and across the termini of all dedications abutting unsubdivided property. The 1-foot dedications on the map shall include a restriction against their use of access purposes until such time as they are accepted for public use.
  - (j) That any 1-foot future street and/or alley adjoining the tract be dedicated for public use by the tract, or that a suitable resolution of acceptance be transmitted to the City Council with the final map.
  - (k) That no public street grade exceeds 15%.
  - (l) That any necessary additional street dedications be provided to comply with the Americans with Disabilities Act (ADA) of 1990.
- S-2. That the following provisions be accomplished in conformity with the improvements constructed herein:
- (a) Survey monuments shall be placed and permanently referenced to the satisfaction of the City Engineer. A set of approved field notes shall be furnished, or such work shall be suitably guaranteed, except where the setting of boundary monuments requires that other procedures be followed.
  - (b) Make satisfactory arrangements with the Department of Traffic with respect to street name, warning, regulatory and guide signs.
  - (c) All grading done on private property outside the tract boundaries in connection with public improvements shall be performed within dedicated slope easements or by grants of satisfactory rights of entry by the affected property owners.
  - (d) All improvements within public streets, private streets, alleys and easements shall be constructed under permit in conformity with plans and specifications approved by the Bureau of Engineering.
  - (e) Any required bonded sewer fees shall be paid prior to recordation of the final map.
- S-3. That the following improvements are either constructed prior to recordation of the final map or that the construction is suitably guaranteed:
- (a) Construct on-site sewers to serve the tract as determined by the City Engineer.
  - (b) Construct any necessary drainage facilities.
  - (c) Install street lighting facilities to serve the tract as required by the Bureau of Street Lighting.
    - (1) No street lighting improvements if no street widening per BOE improvement conditions. Otherwise relocate and upgrade street light; one (1) on Mississippi Avenue.

Notes:

The quantity of street lights identified may be modified slightly during the plan check process based on illumination calculations and equipment selection.



Conditions set: 1) in compliance with a Specific Plan, 2) by LADOT, or 3) by other legal instrument excluding the Bureau of Engineering condition S-3 (i), requiring an improvement that will change the geometrics of the public roadway or driveway apron may require additional or the reconstruction of street lighting improvements as part of that condition.

- (d) Plant street trees and remove any existing trees within dedicated streets or proposed dedicated streets as required by the Street Tree Division of the Bureau of Street Maintenance. All street tree plantings shall be brought up to current standards. When the City has previously been paid for tree planting, the subdivider or contractor shall notify the Urban Forestry Division ((213) 847-3077) upon completion of construction to expedite tree planting.
- (e) Repair or replace any off-grade or broken curb, gutter and sidewalk satisfactory to the City Engineer.
- (f) Construct access ramps for the handicapped as required by the City Engineer.
- (g) Close any unused driveways satisfactory to the City Engineer.
- (h) Construct any necessary additional street improvements to comply with the 2010 Americans with Disabilities Act (ADA) Standards for Accessible Design.
- (i) That the following improvements are either constructed prior to recordation of the final map or that the construction is suitably guaranteed:
  - (1) Improve Mississippi adjoining the subdivision by the removal of existing sidewalk and construction of a 5-foot wide concrete sidewalk and landscaping of parkway, or a full-width concrete sidewalk with tree wells, including any necessary removal and reconstruction of existing improvements.

Any questions regarding this report should be directed to Julia Li of the Land Development Section, located at 201 North Figueroa Street, Suite 290, or by calling (213) 808-8431.

#### NOTES:

The Advisory Agency approval is the maximum number of units permitted under the parcel map action. However the existing or proposed zoning may not permit this number of units.

Any removal of the existing street trees shall require Board of Public Works approval.

Satisfactory arrangements shall be made with the Los Angeles Department of Water and Power, Power System, to pay for removal, relocation, replacement or adjustment of power facilities due to this development. The subdivider must make arrangements for the underground installation of all new utility lines in conformance with Section 17.05-N of the Los Angeles Municipal Code (LAMC).

The final map must be recorded within 36 months of this approval, unless a time extension is granted before the end of such period.

The Advisory Agency hereby finds that this tract conforms to the California Water Code, as required by the Subdivision Map Act.

The subdivider should consult the Department of Water and Power to obtain energy saving design features which can be incorporated into the final building plans for the subject development. As part of the Total Energy Management Program of the Department of Water and Power, this no-cost consultation service will be provided to the subdivider upon his request.

### **FINDINGS OF FACT (CEQA)**

DETERMINED based on the whole of the administrative record, that the Project is exempt from CEQA pursuant to CEQA Guidelines, Section, 15315 (Class 15) and 15332 (Class 32), and there is no substantial evidence demonstrating that an exception to a categorical exemption pursuant to CEQA Guidelines, Section 15300.2 applies.

### **FINDINGS OF FACT (SUBDIVISION MAP ACT)**

In connection with the approval of Parcel Map No. AA-2017-5222 the Advisory Agency of the City of Los Angeles, pursuant to Sections 66473.1, 66474.60, .61 and .63 of the State of California Government Code (the Subdivision Map Act), makes the prescribed findings as follows:

- (a) **THE PROPOSED MAP WILL BE/IS CONSISTENT WITH APPLICABLE GENERAL AND SPECIFIC PLANS.**

The Land Use Element of the General Plan consists of the 35 Community Plans within the City of Los Angeles. The Community Plans establish goals, objectives, and policies for future developments at a neighborhood level. Additionally, through the Land Use Map, the Community Plan designates parcels with a land use designation and zone. The Land Use Element is further implemented through the Los Angeles Municipal Code (LAMC). The zoning regulations contained within the LAMC regulates, but is not limited to, the maximum permitted density, height, parking, and the subdivision of land. The site is within the West Los Angeles Transportation Improvement and Mitigation Specific Plan area, which does not address development issues. It identifies trip fee requirements for non-residential projects.

The subdivision of land is regulated pursuant to Article 7 of the LAMC. Pursuant to LAMC Section 17.50, parcel maps are to be designed in conformance with the parcel map regulations to ensure compliance with the various elements of the General Plan, including the Zoning Code. Additionally, the maps are to be designed in conformance with the Street Standards established pursuant to LAMC Section 17.05 B. The project site is located within the West Los Angeles Community Plan, which designates the site with a Low Medium I Residential land use designation. The land use designation lists the R2, RD3, RD4, RZ3, RZ4, RU, and RW1 Zones as the corresponding zones. The Project Site is zoned R2-1, which is consistent with the land use designation. The project site has approximately 10,760 square feet of lot area, which would permit a maximum of four (4) dwelling units. As shown on the parcel map, the Project proposes to subdivide the project site into two (2) parcels with two (2) dwelling units each, for a total of four (4) dwelling units, which is consistent with the density permitted by the zone.

Pursuant to LAMC Section 17.51 A, a preliminary parcel map is not required to be prepared by a licensed land surveyor or registered civil engineer, but is required to contain information regarding the boundaries of the project site, as well as the abutting public rights-of-way, hillside contours for hillside properties, location of existing buildings, existing and proposed dedication, and improvements of the tract map. The parcel map was prepared by a registered civil engineer (Reynaldo T. De Rama, License No. C29108). The parcel map indicates the parcel map number, notes, legal description, contact information for the owner, applicant, and engineer, as well as other pertinent information as required by LAMC Section 17.51 A. Therefore, the proposed map demonstrates compliance with LAMC Sections 17.05 C and 17.06 B and is consistent with the applicable General Plan.

- (b) THE DESIGN OR IMPROVEMENT OF THE PROPOSED SUBDIVISION IS CONSISTENT WITH APPLICABLE GENERAL AND SPECIFIC PLANS.

For purposes of a subdivision, design and improvement is defined by Section 66418 and 66419 of the Subdivision Map Act and LAMC Section 17.02. Design refers to the configuration and layout of the proposed lots in addition to the proposed site plan layout. Pursuant to Section 66427(a) of the Subdivision Map Act, the location of the buildings is not considered as part of the approval or disapproval of the map by the Advisory Agency. Easements and/or access and "improvements" refers to the infrastructure facilities serving the subdivision. LAMC Section 17.50 and 17.05 enumerates the design standards for a parcel map and requires that each map be designed in conformance with the Street Design Standards and in conformance with the General Plan. As indicated in Finding (a), LAMC Section 17.05 C requires that the parcel map be designed in conformance with the zoning regulations of the project site. As the project site is zoned R2-1, the zone would permit a maximum of two (2) lots and four (4) dwelling units on the approximately 10,760 square-foot site. As the map is proposed for a two-parcel condominium subdivision for a total of four (4) dwelling units, it is consistent with the density permitted by the zone.

The parcel map was distributed to and reviewed by the various city agencies of the Subdivision Committee that have the authority to make dedication, and/or improvement recommendations. The Bureau of Engineering reviewed the parcel map for compliance with the Street Design Standards. The Bureau of Engineering has recommended dedication and/or improvements to the public right-of-way along Mississippi Avenue, consistent with the standards of the Mobility Element. In addition, the Bureau of Engineering has recommended the construction of the necessary on-site mainline sewers and all necessary street improvements will be made to comply with the Americans with Disabilities Act (ADA) of 2010. As conditioned, the design and improvements of the proposed subdivision are consistent with the applicable General Plan.

- (c) THE SITE IS PHYSICALLY SUITABLE FOR THE TYPE OF DEVELOPMENT.

The project site is comprised of two (2) parcels totaling 10,760 square feet in lot area. The site is currently developed with two single-family dwellings with detached garages and seven non-protected trees. The project proposes the demolition of the existing structures, removal of the existing trees, and construction of four (4) new detached condominiums.

The project site is located within 1.075 km (0.66 miles) from the Santa Monica Fault, but is not located within the Alquist-Priolo Fault Zone. The site is not located within a designated hillside area or within the BOE Special Grading Area. The site is not located within a high fire hazard severity zone, flood zone, landslide, liquefaction, methane, or tsunami inundation zone. Prior to the issuance of any permits, the project would be required to be reviewed and approved by the Department of Building and Safety and the Fire Department. The site is not identified as having hazardous waste or past remediation. The site is located outside the flood zone.

The parcel map has been approved contingent upon the satisfaction of the Department of Building and Safety, Grading Division (Soils Report Approval Letter Log # 98976) prior to the recordation of the map and issuance of any permits. Therefore, the site will be physically suitable for the proposed type of development.

- (d) THE SITE IS PHYSICALLY SUITABLE FOR THE PROPOSED DENSITY OF DEVELOPMENT.

Surrounding parcels are zoned R2-1, R3-1, and (Q)RD3-1. The property to the east is improved with a Fire Department training facility that ranges from one to two stories in height. The property to the west is improved with a one-story duplex. Properties across Mississippi Avenue to the north are improved with duplexes and new construction ranging from one to three stories in height.

The project site is comprised of two (2) parcels totaling 10,760 square feet in lot area. The site is currently developed with two single-family dwellings with detached garages and seven non-protected trees. The project proposes the demolition of the existing structures, removal of the existing trees, and construction of four (4) new detached condominiums. The condominiums would be three stories and 33 feet in height. As proposed, the density and height is consistent with the zone and land use designation, which would permit a maximum of 4 dwelling units and a height of 33 feet. The parcel map has been approved contingent upon the satisfaction of the Department of Building and Safety, Grading Division (Soils Report Approval Letter Log # 98976) prior to the recordation of the map and issuance of any permits. Additionally, prior to the issuance of a demolition, grading, or building permit, the project would be required to comply with conditions herein and applicable requirements of the LAMC. As conditioned the proposed parcel map is physically suitable for the proposed density of the development.

- (e) THE DESIGN OF THE SUBDIVISION OR THE PROPOSED IMPROVEMENTS ARE NOT LIKELY TO CAUSE SUBSTANTIAL ENVIRONMENTAL DAMAGE OR SUBSTANTIALLY AND AVOIDABLY INJURE FISH OR WILDLIFE OR THEIR HABITAT.

The project site is currently developed with two single-family dwellings with detached garages. There are seven (7) non-protected trees on the project site. The surrounding area is presently developed with structures including a Fire Department training facility, and multi-family residential buildings ranging from one to three stories in height. Neither the project site nor the surrounding area provides a natural habitat for fish or wildlife. It has been determined that the project and the design of the subdivision and proposed improvements will not cause substantial environmental damage or injury to wildlife or their habitat.

- (f) THE DESIGN OF THE SUBDIVISION OR TYPE OF IMPROVEMENTS IS NOT LIKELY TO CAUSE SERIOUS PUBLIC HEALTH PROBLEMS.

There appears to be no potential public health problems caused by the design or improvement of the proposed subdivision.

The development is required to be connected to the City's sanitary sewer system, where the sewage will be directed to the LA Hyperion Treatment Plant, which has been upgraded to meet Statewide ocean discharge standards. The Bureau of Engineering has reported that the proposed subdivision does not violate the existing California Water Code because the subdivision will be connected to the public sewer system and will have only a minor incremental impact on the quality of the effluent from the Hyperion Treatment Plant.

- (g) THE DESIGN OF THE SUBDIVISION OR THE TYPE OF IMPROVEMENTS WILL NOT CONFLICT WITH EASEMENTS, ACQUIRED BY THE PUBLIC AT LARGE, FOR ACCESS THROUGH OR USE OF PROPERTY WITHIN THE PROPOSED SUBDIVISION.

As required by LAMC Section 12.03, the project site has a minimum of 20 feet of frontage along Mississippi Avenue, which is a public street. The project site consists of parcels identified as Lot Nos. 2 and 3 of Tract 8725 and are identified by the Assessor Parcel Map Nos. 4260-005-002 and 4260-005-003. While the project will provide a private easement for common/vehicular access purposes within the subdivision, there are no known easements acquired by the public at large for access through or use of the property within

the proposed subdivision, as identified on the tract map. Necessary easements for utilities will be acquired by the City prior to the recordation of the proposed parcel map.

Therefore, the design of the subdivision and the proposed improvements would not conflict with easements acquired by the public at large for access through or use of the property within the proposed subdivision.

- (h) THE DESIGN OF THE PROPOSED SUBDIVISION SHALL PROVIDE, TO THE EXTENT FEASIBLE, FOR FUTURE PASSIVE OR NATURAL HEATING OR COOLING OPPORTUNITIES IN THE SUBDIVISION. (REF. SECTION 66473.1)

In assessing the feasibility of passive or natural heating or cooling opportunities in the proposed subdivision design, the applicant has prepared and submitted materials which consider the local climate, contours, configuration of the parcel(s) to be subdivided and other design and improvement requirements.

Providing for passive or natural heating or cooling opportunities will not result in reducing allowable densities or the percentage of a lot which may be occupied by a building or structure under applicable planning and zoning in effect at the time the tentative map was filed.

The lot layout of the subdivision has taken into consideration the maximizing of the north/south orientation.

The topography of the site has been considered in the maximization of passive or natural heating and cooling opportunities.

In addition, prior to obtaining a building permit, the subdivider shall consider building construction techniques, such as overhanging eaves, location of windows, insulation, exhaust fans; planting of trees for shade purposes and the height of the buildings on the site in relation to adjacent development.

These findings shall apply to both the tentative and final maps for Parcel Map No. AA-2017-5222-PMLA.

THE FOLLOWING NOTES ARE FOR INFORMATIONAL PURPOSES AND ARE NOT CONDITIONS OF APPROVAL OF THIS PARCEL MAP:

Satisfactory arrangements shall be made with the Los Angeles Department of Water and Power, Power System, to pay for removal, relocation, replacement or adjustment of power facilities due to this development. The subdivider must make arrangements for the underground installation of all new utility lines in conformance with Section 17.05-N of the Los Angeles Municipal Code (LAMC).

Note: The above action shall become effective upon the decision date noted at the top of this letter unless an appeal has been submitted to the Central Area Planning Commission within 15 calendar days of the decision date. If you wish to file an appeal, it must be filed within 15 calendar days from the decision date as noted in this letter. For an appeal to be valid to the City Planning Commission, it must be accepted as complete by the City Planning Department and appeal fees paid, prior to expiration of the above 15-day time limit. Such appeal must be submitted on Master Appeal Form No. CP-7769 at the Department's Public Offices, located at:

Figueroa Plaza  
201 North Figueroa Street  
4th Floor  
Los Angeles, CA 90012  
(213) 482-7077

Marvin Braude San Fernando  
Valley Constituent Service Center  
6262 Van Nuys Boulevard, Room 251  
Van Nuys, CA 91401  
(818) 374-5050

West Los Angeles  
Development Service Center  
1828 Sawtelle Boulevard, 2nd Floor  
Los Angeles, CA 90025  
(310) 231-2901

**\*Please note the cashiers at the public counters close at 3:30 PM.  
Appeal forms are available on-line at [www.planning.lacity.org](http://www.planning.lacity.org).**

Pursuant to Ordinance 176,321, effective January 15, 2005, Parcel Map determinations are only appealable to the Area Planning Commission. There is no longer a second level of appeal to the City Council for Parcel Map actions of the Advisory Agency.

The time in which a party may seek judicial review of this determination is governed by California Code of Civil Procedure Section 1094.6. Under that provision, a petitioner may seek judicial review of any decision of the City pursuant to California Code of Civil Procedure Section 1094.5, only if the petition for writ of mandate pursuant to that section is filed no later than the 90th day following the date on which the City's decision becomes final, including all appeals, if any.

No sale of separate parcels is permitted prior to recordation of the final parcel map. The owner is advised that the above action must record within 36 months of this approval, unless an extension of time is granted before the end of such period. No requests for time extensions or appeals received by mail shall be accepted.

VINCENT P. BERTONI, AICP  
Advisory Agency

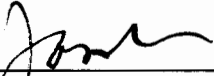
  
\_\_\_\_\_  
JASON CHAN  
Deputy Advisory Agency

JC:CC

# PRELIMINARY PARCEL MAP - AA 2017-5222-PMLA

## FOR CONDOMINIUM PURPOSES

LOTS 2 AND 3 OF TRACT NO. 8725, IN THE CITY OF LOS ANGELES, COUNTY OF LOS ANGELES, STATE OF CALIFORNIA AS PER MAP RECORDED IN BOOK 112 PAGE 98 OF MAPS, IN THE OFFICE OF COUNTY RECORDER OF SAID COUNTY.

APN: 4260-005-002 & APN: 4260-005-003

LOS ANGELES DEPT. OF CITY PLANNING  
SUBMITTED FOR FILING  
PARCEL MAP

NOV 19 2013

REVISER'S MAP EXTENSION OF TIME  
FINAL MAP UNIT MODIFIED  
DEPUTY ADVISORY AGENCY



VICINITY MAP  
N.T.S.

### MISSISSIPPI AVE

### COLBY AVENUE

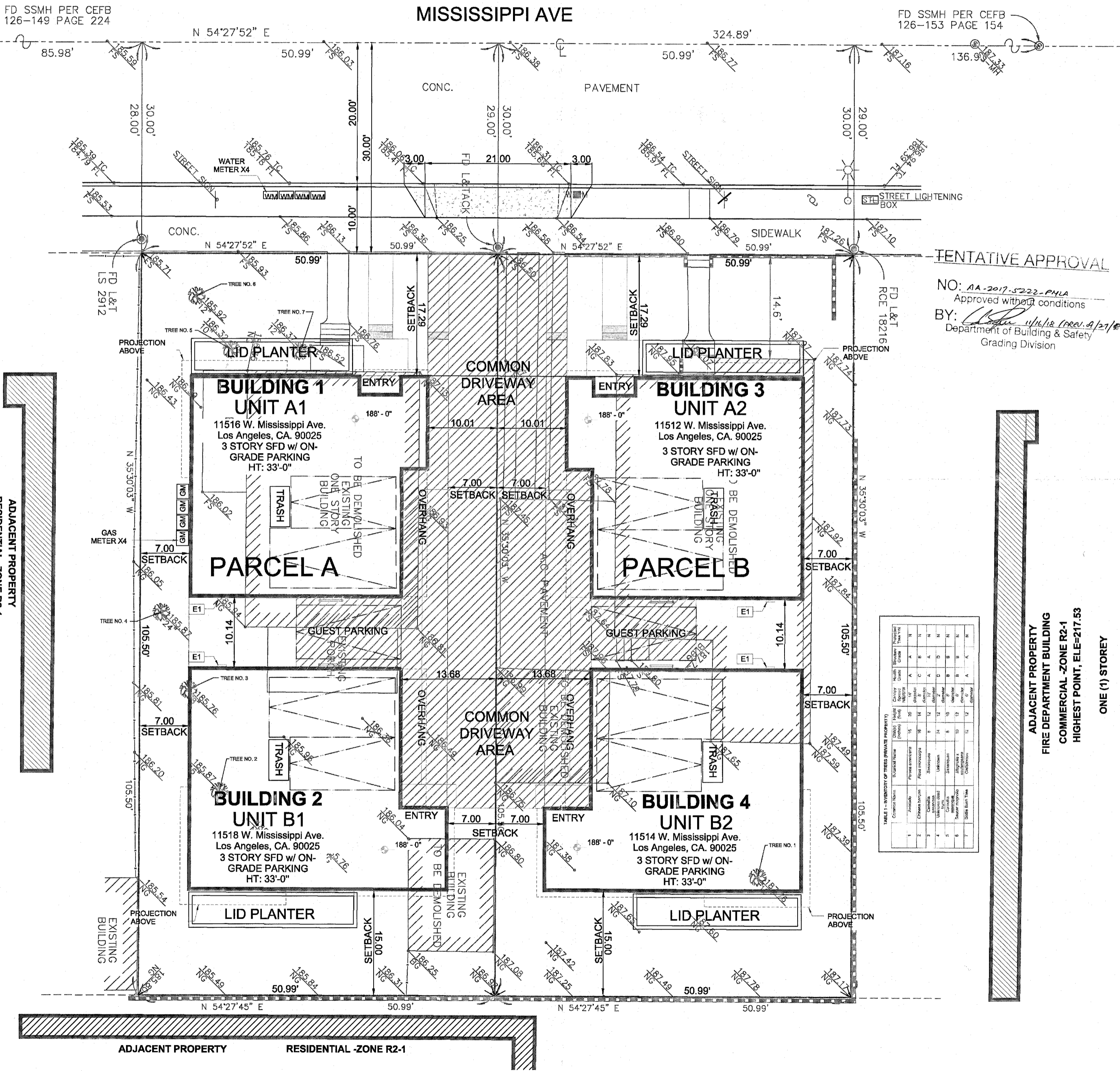

TENTATIVE APPROVAL

NO: AA-2017-5222-PMLA  
Approved without conditions  
BY: [Signature]  
Department of Building & Safety  
Grading Division

### TRACT MAP NOTES

OWNER & SUBDIVIDER:  
FOCUS LINE LLC  
160 DELFERN DR # 1050  
LOS ANGELES, CA 90077  
(818) 517-5171

SITE ADDRESS:  
11512 -16 MISSISSIPPI AVE  
LOS ANGELES, CA 90025

GROSS AREA: 13,819.01 SQ. FT. = 0.317 ACRES  
PIQ + HALF OF MISSISSIPPI AVENUE

NET- AREA:  
10,759.59 SQ. FT. = 0.247 ACRES PIQ ONLY

### NOTES:

- NO PROTECTED SPECIES ON THE SITE.
- 7 PRIVATE PROPERTY TREES ARE TO BE REMOVED
- ALL UTILITIES ARE AVAILABLE TO SITE.
- PROPOSED PROJECT: 4 UNIT RESIDENTIAL CONDOMINIUM
- EXISTING ZONE: R2 - 1, PROPOSED ZONE: SAME
- PROPOSED PARKING SPACES: 10 PARKING SPACES  
2 PARKING PER UNIT  
2 GUEST PARKING
- ALL EXISTING STRUCTURES TO BE DEMOLISHED.
- NO GEOLOGICAL HAZARDOUS AREA.
- SEWER IS AVAILABLE TO THE SITE.
- SITE IS NOT IN LIQUEFACTION.
- NO ROOF DECK.
- TRASH STORED INTERNALLY IN GARAGES.

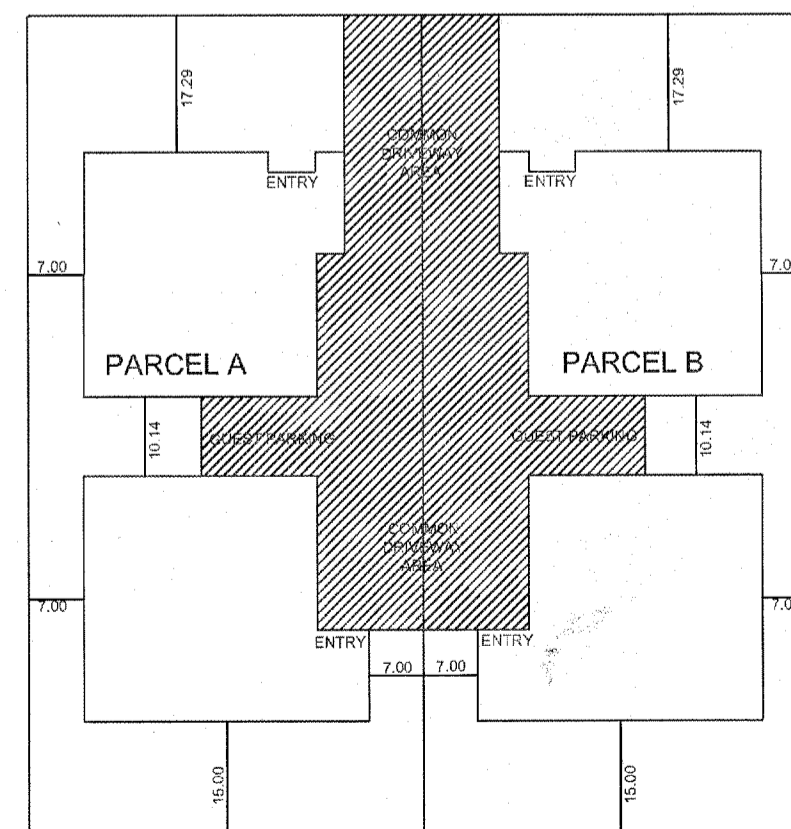

DETAIL - A:  
COMMON DRIVEWAY DETAIL

PLANS PREPARED BY:  
TALA ASSOCIATES  
REYNALDO T DE RAMA  
R.C.E. 29108

1916 COLBY AVENUE  
LOS ANGELES, CA 90025  
PHONE (424) 832-3455  
FAX (310) 473-5968

JN3536 DATE: OCTOBER 4, 2017

